

SHF-N-525

Coxreels 3/4" Petrol & Diesel Spring Rewind Hose Reel

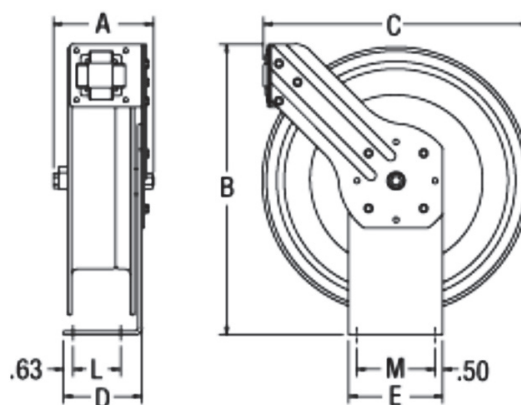
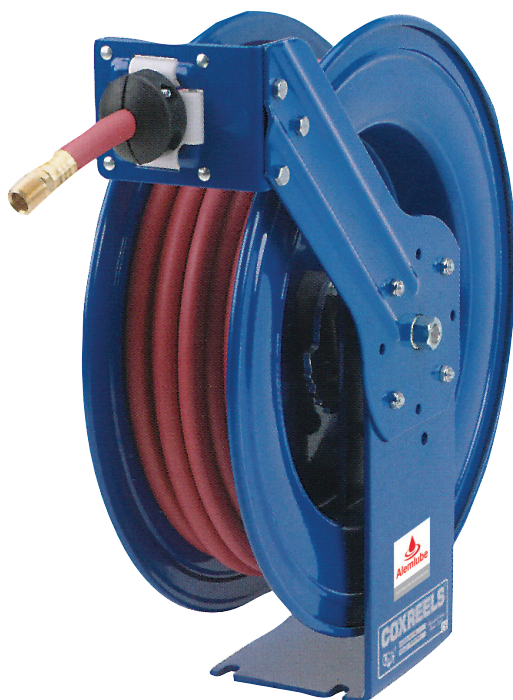

A = 24cm

L = 10.25cm

D = 15.25cm

B = 53.5cm

C = 49.5cm

M = 12.75cm

E = 15.25cm



September 2020

The Coxreels SHF-N-525 Spring Rewind Hose Reel has a history of dependable performance. The larger chassis and frame accommodate longer lengths and larger diameters of hose.

A dual axle support system increases the stability during operation, reduces vibration and strengthens the structural integrity of the reel. Supplied standard with antistatic 8m x 3/4" ID hose the SHF-N-525 has a pressure rating of up to 300psi.

Auto rewind easily wraps, stores & protects the hose effectively offering a longer service life.

Signature features of the SHF-N-525 3/4" ID spring rewind hose reel include professional grade heavy duty steel construction, rolled edges and ribbed disc providing strength and safety, durable, powder coat finish and multi-position lock ratchet to secure the hose at any desired length.

SPECIFICATIONS, FEATURES AND BENEFITS

- Dual axle support points to the centre shaft with Coxreels' original super hub™ axle support system
- 8m x 3/4" ID hose
- Pressure of up to 300psi (21bar)
- Swivel seals: NITRILE
- Auto rewind easily wraps, stores & protects hose
- Heavy gauge 1/4" steel base & support post
- Factory-matched cartridge-style spring motor
- Solid machined brass swivel
- 1" solid steel axle with 1" lubricated precision bearings
- Guide arm adjusts to wall, floor & overhead positions
- Multi-position lock ratchet secures hose at the desired length
- Non-corrosive stainless steel spring, pawl & zinc plated ratchet
- Professional grade heavy duty steel construction
- Durable proprietary cpc® powder coat process™
- Rolled edges & ribbed discs provide strength & safety

Also available:

- SHL-N-525 Bare reel

