

Description

The Alemlube 2" PR50 and the 3" PR80 petrol driven transfer engine pumps are specifically designed and manufactured for the transfer of diesel and water. Mounted in a robust tubular steel roll frame with rubber feet the PR50 and the PR80 are completely portable, suit many industrial, workshop, agricultural, municipal, marine services and on site applications including construction site dewatering and are capable of transferring up to 620L/min (PR50) and 1000L/min (PR80) of diesel fuel or water per minute.

Driven by a powerful OHC 4 stroke air cooled petrol engine these lightweight die-cast aluminium pumps are fitted with 2" (PR50) and 3" (PR80) diameter inlet & outlet ports that operate efficiently with a maximum suction head of 8 metres and a maximum lift head of 28 metres (PR50) and 32 metres (PR80).

Always ready to perform tank filling, diesel or water transfer the PR50 and the PR80 have a 3.8L fuel tank capacity with a manual starting system.

Specifications

Uses	Diesel and water transfer
Engine Type	OHC 4 stroke, Air Cooled
Maximum Flow Rate	620 L/min (PR50) 1000 L/min (PR80)

IMPORTANT

Please make certain that persons who are to use this equipment thoroughly read and understand these instructions and any additional instructions provided prior to operation.

NOTE

No refund or exchange once petrol is placed into the fuel tank.

Warranty registration must be complete within 30 days of purchase with proof of purchase.



TABLE OF CONTENTS

1. SAFETY	3
2. BEFORE STARTING	4
3. STARTING THE ENGINE	5
4. STARTING THE ENGINE	6
5. MAINTENANCE	7
6. MAINTENANCE	8
7. TROUBLE SHOOTING	9

NSW/ACT

TEL: (02) 9677 1555
FAX: (02) 9675 1155

QLD/PNG

TEL: (07) 3204 9166
FAX: (07) 3204 1224

VIC/TAS

TEL: (03) 8787 8288
FAX: (03) 8787 8266

WA

TEL: (08) 9302 4199
FAX: (08) 9303 2095

SA/NT

TEL: (08) 8241 7111
FAX: (08) 8241 7011

NZ

TEL: (64) 9 447 1007
FAX: (64) 9 447 1008

SAFETY

1.

BE CAREFUL!



NOT FOR USE INDOORS

KEEP AWAY FROM ANYTHING FLAMMABLE

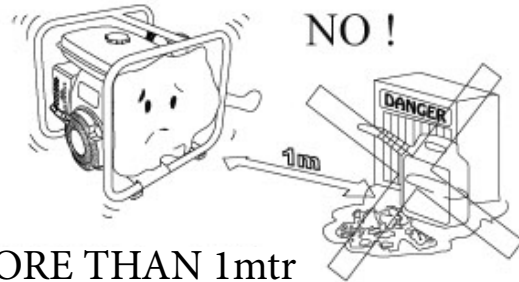

ALLOW MORE THAN 1mtr

WHEN REFUELLING



STOP ENGINE!



NO SMOKING!



DO NOT SPILL!

NSW/ACT

TEL: (02) 9677 1555
FAX: (02) 9675 1155

QLD/PNG

TEL: (07) 3204 9166
FAX: (07) 3204 1224

VIC/TAS

TEL: (03) 8787 8288
FAX: (03) 8787 8266

WA

TEL: (08) 9302 4199
FAX: (08) 9303 2095

SA/NT

TEL: (08) 8241 7111
FAX: (08) 8241 7011

NZ

TEL: (64) 9 447 1007
FAX: (64) 9 447 1008

BEFORE STARTING

2.

1. CONNECT HOSE

1. INSERT

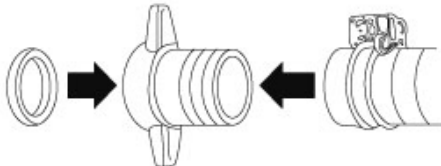

2. TIGHTEN

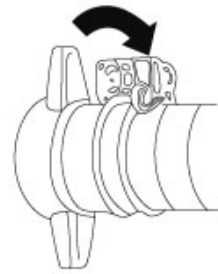

3. SCREW IN

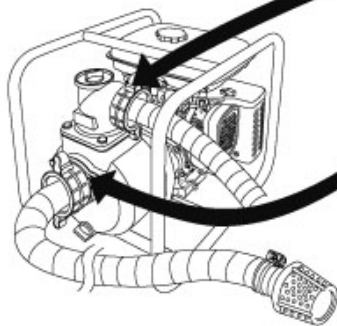

3. INSERT

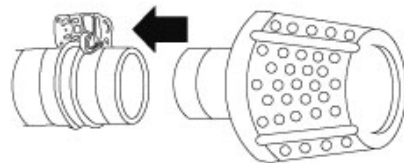
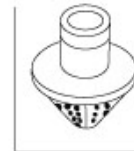

4. TIGHTEN

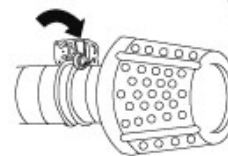

2. FILL TANK

1. REMOVE PLUG

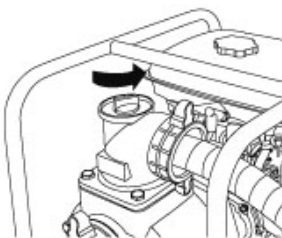

2. FILL TANK

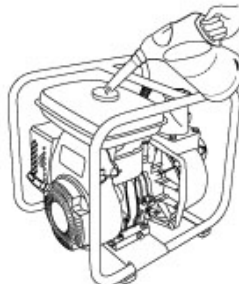

3. INSTALL PLUG

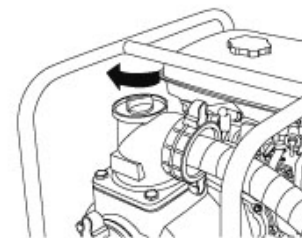

NSW/ACT

TEL: (02) 9677 1555
FAX: (02) 9675 1155

QLD/PNG

TEL: (07) 3204 9166
FAX: (07) 3204 1224

VIC/TAS

TEL: (03) 8787 8288
FAX: (03) 8787 8266

WA

TEL: (08) 9302 4199
FAX: (08) 9303 2095

SA/NT

TEL: (08) 8241 7111
FAX: (08) 8241 7011

NZ

TEL: (64) 9 447 1007
FAX: (64) 9 447 1008

STARTING THE ENGINE

3.

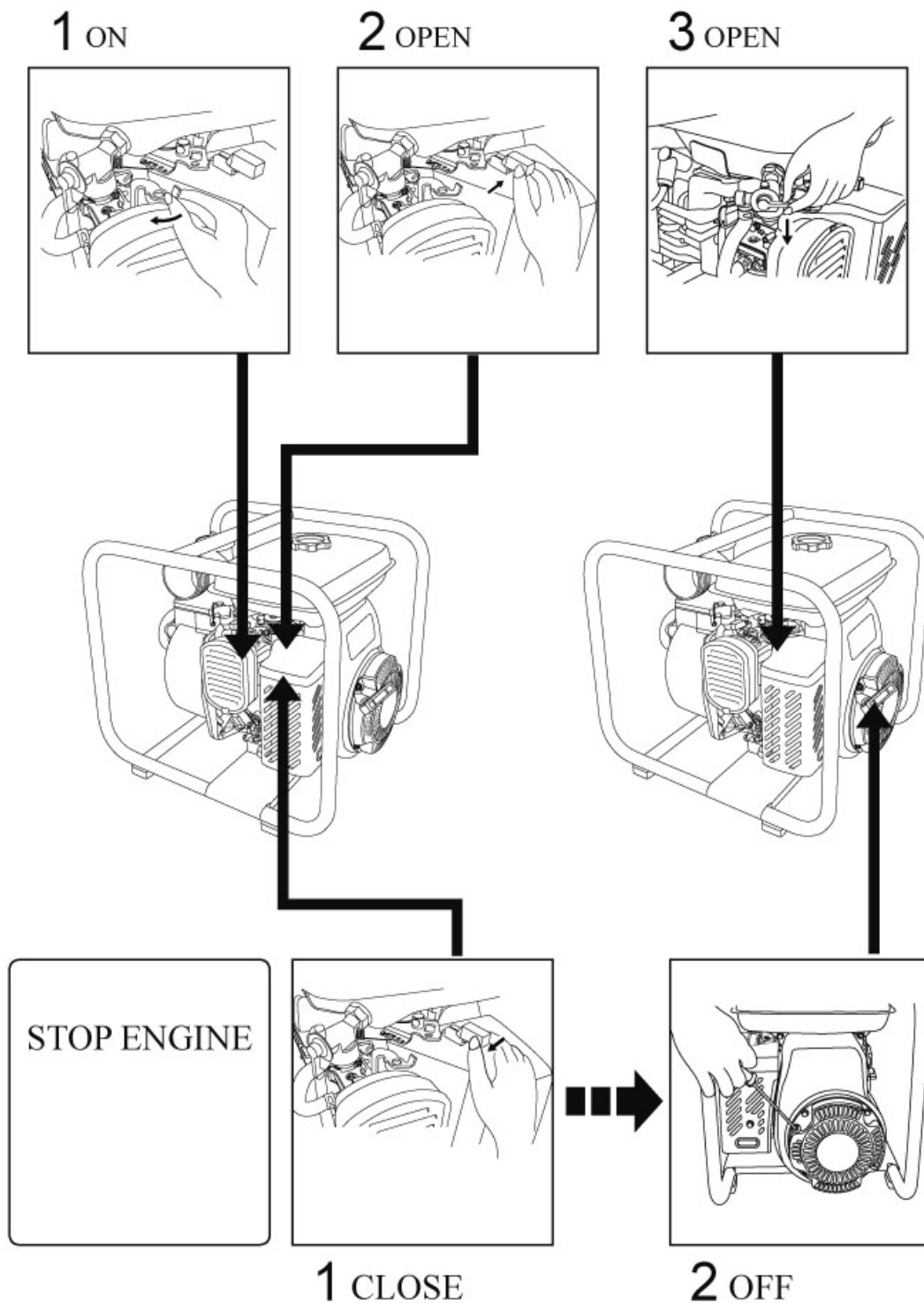

NSW/ACT
TEL: (02) 9677 1555
FAX: (02) 9675 1155

QLD/PNG
TEL: (07) 3204 9166
FAX: (07) 3204 1224

VIC/TAS
TEL: (03) 8787 8288
FAX: (03) 8787 8266

WA
TEL: (08) 9302 4199
FAX: (08) 9303 2095

SA/NT
TEL: (08) 8241 7111
FAX: (08) 8241 7011

NZ
TEL: (64) 9 447 1007
FAX: (64) 9 447 1008

STARTING THE ENGINE

4.

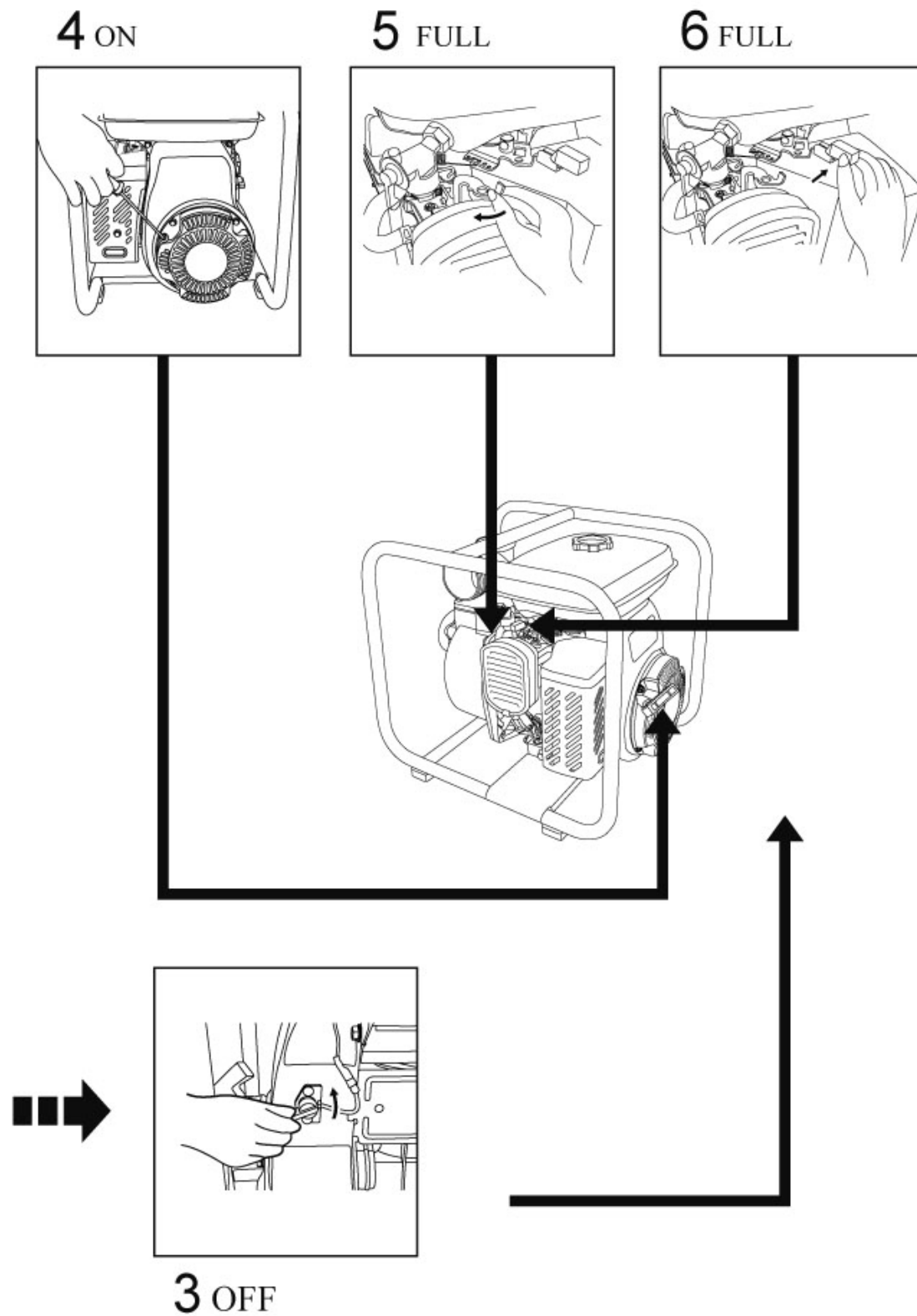

NSW/ACT
TEL: (02) 9677 1555
FAX: (02) 9675 1155

QLD/PNG
TEL: (07) 3204 9166
FAX: (07) 3204 1224

VIC/TAS
TEL: (03) 8787 8288
FAX: (03) 8787 8266

WA
TEL: (08) 9302 4199
FAX: (08) 9303 2095

SA/NT
TEL: (08) 8241 7111
FAX: (08) 8241 7011

NZ
TEL: (64) 9 447 1007
FAX: (64) 9 447 1008

MAINTENANCE

5.

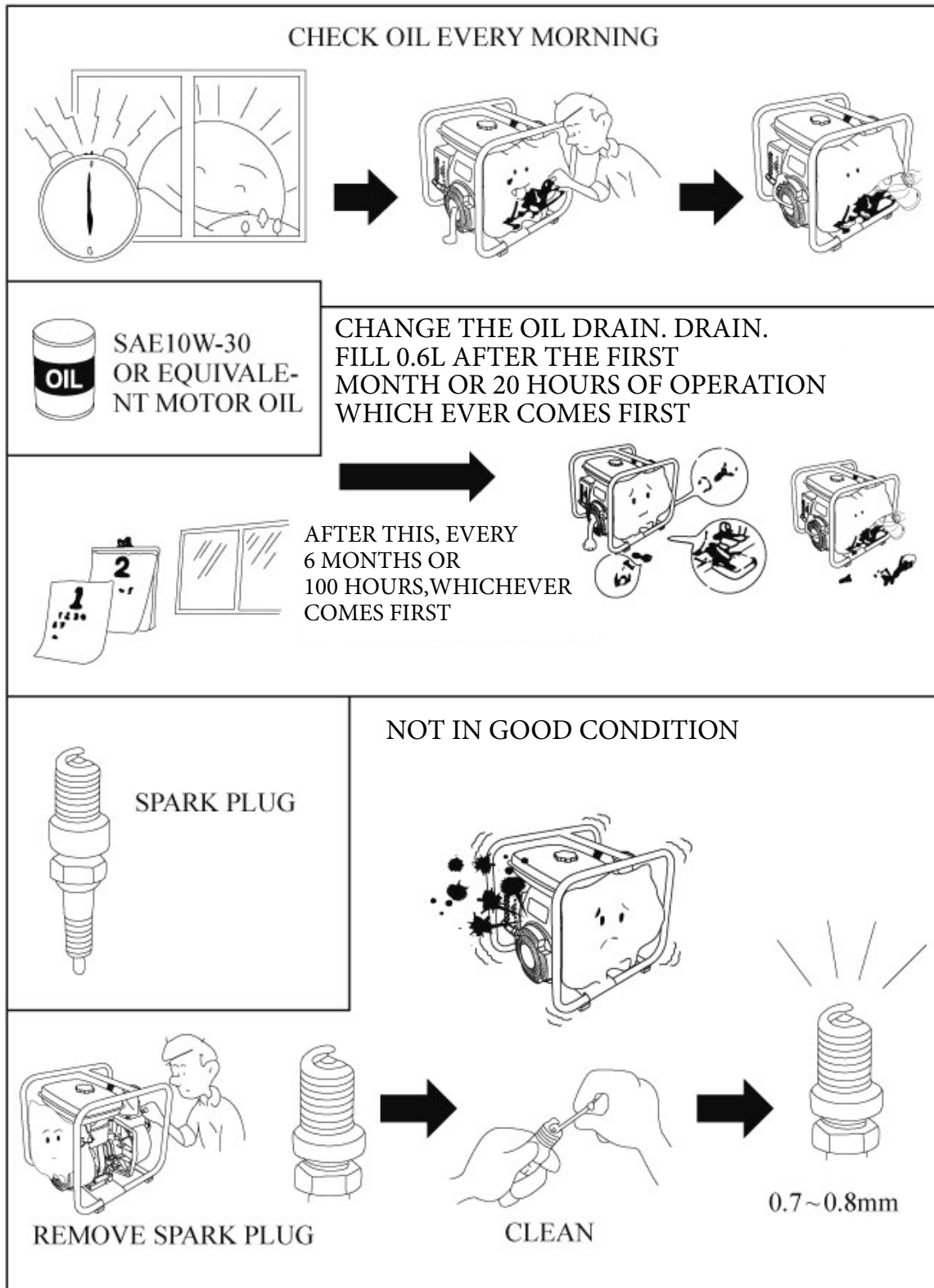

NSW/ACT
TEL: (02) 9677 1555
FAX: (02) 9675 1155

QLD/PNG
TEL: (07) 3204 9166
FAX: (07) 3204 1224

VIC/TAS
TEL: (03) 8787 8288
FAX: (03) 8787 8266

WA
TEL: (08) 9302 4199
FAX: (08) 9303 2095

SA/NT
TEL: (08) 8241 7111
FAX: (08) 8241 7011

NZ
TEL: (64) 9 447 1007
FAX: (64) 9 447 1008

MAINTENANCE

6.

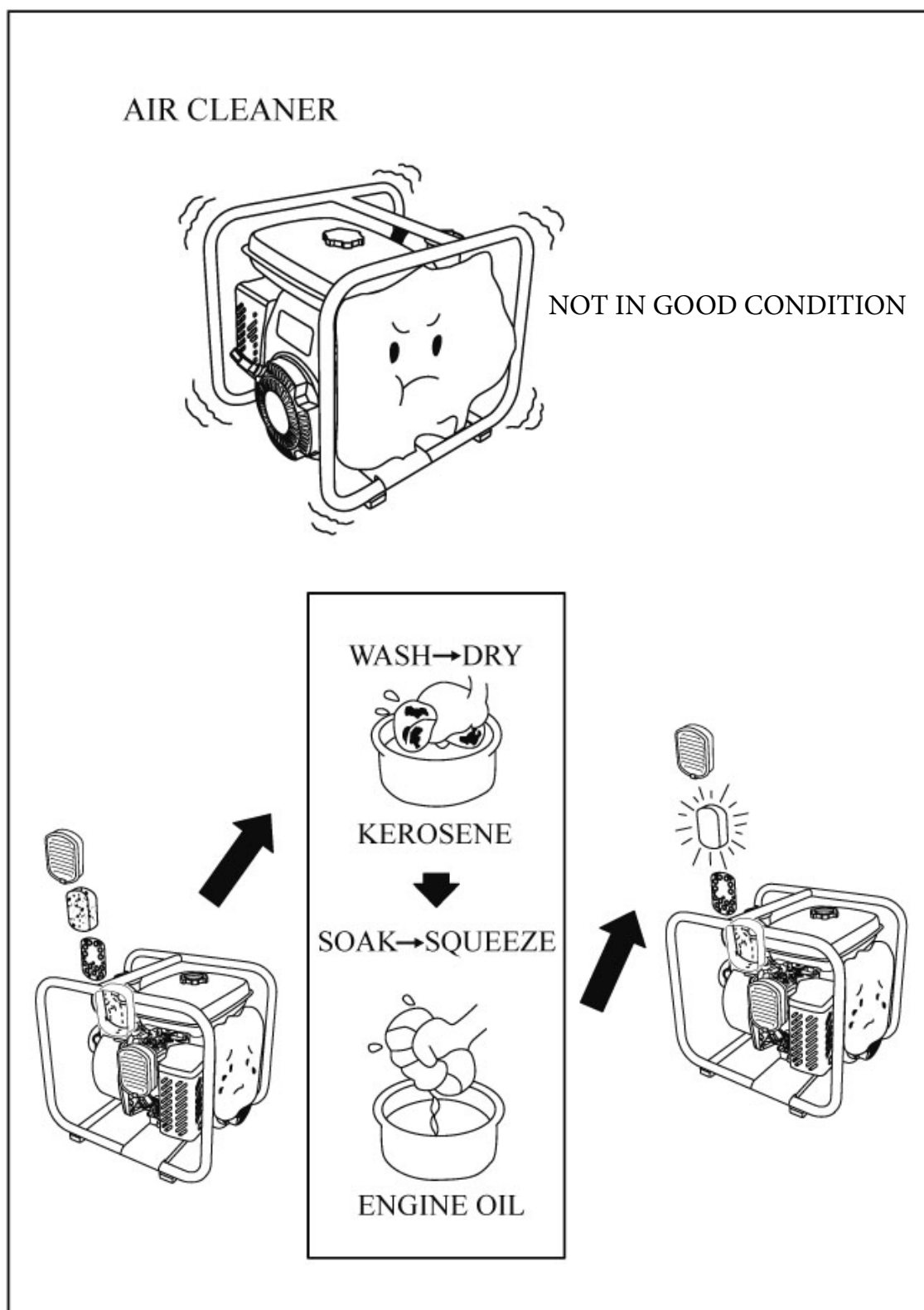

NSW/ACT
TEL: (02) 9677 1555
FAX: (02) 9675 1155

QLD/PNG
TEL: (07) 3204 9166
FAX: (07) 3204 1224

VIC/TAS
TEL: (03) 8787 8288
FAX: (03) 8787 8266

WA
TEL: (08) 9302 4199
FAX: (08) 9303 2095

SA/NT
TEL: (08) 8241 7111
FAX: (08) 8241 7011

NZ
TEL: (64) 9 447 1007
FAX: (64) 9 447 1008

TROUBLE SHOOTING

7.

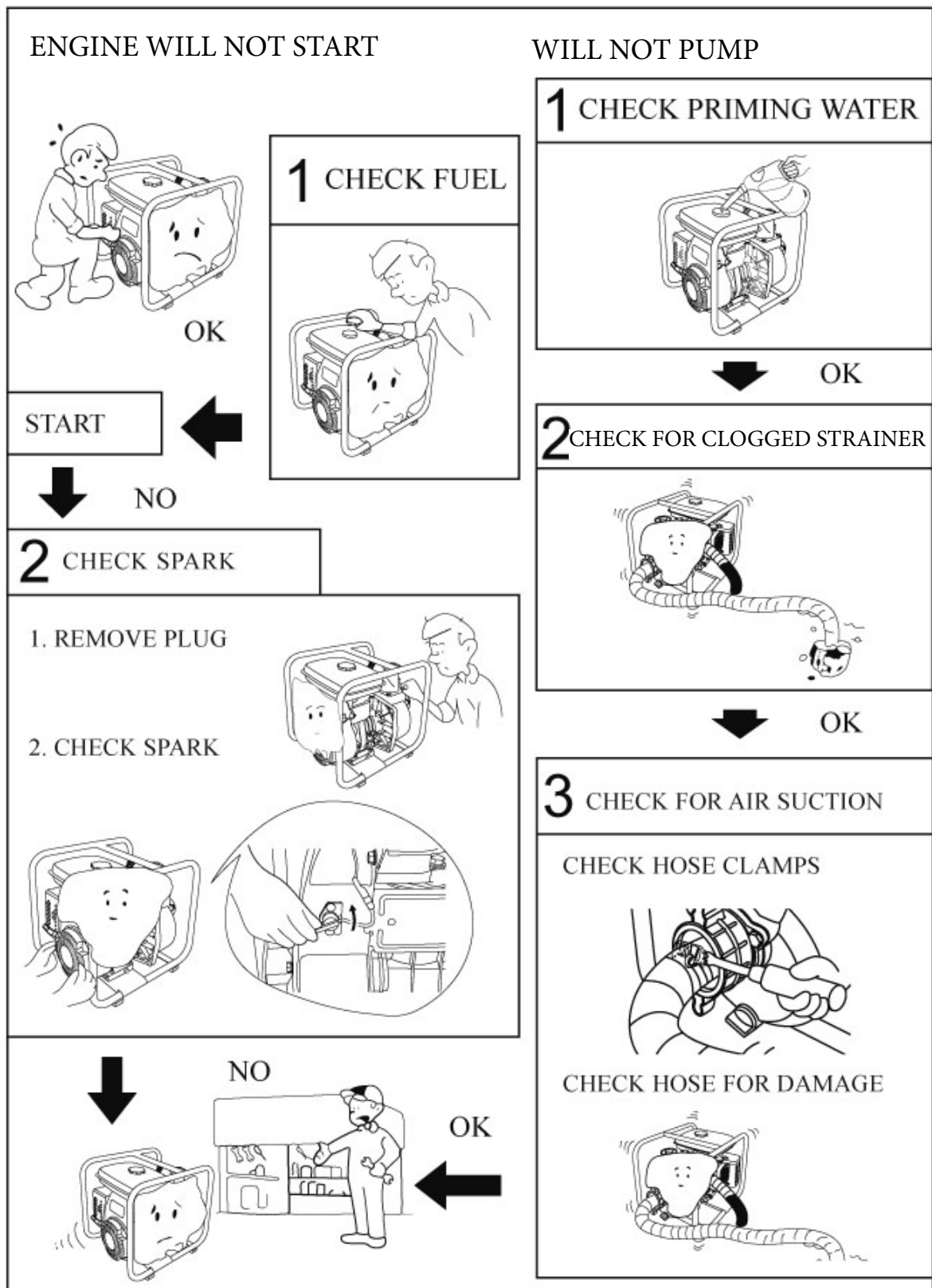

NSW/ACT

TEL: (02) 9677 1555
FAX: (02) 9675 1155

QLD/PNG

TEL: (07) 3204 9166
FAX: (07) 3204 1224

VIC/TAS

TEL: (03) 8787 8288
FAX: (03) 8787 8266

WA

TEL: (08) 9302 4199
FAX: (08) 9303 2095

SA/NT

TEL: (08) 8241 7111
FAX: (08) 8241 7011

NZ

TEL: (64) 9 447 1007
FAX: (64) 9 447 1008