

TSHF-N-635

## Coxreel 1" Spring Rewind Hose Reel

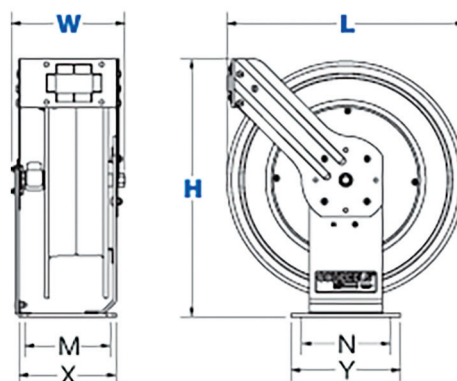

W = 25.4cm

M = 17.75cm

X = 20.25cm

H = 64.75cm

L = 61cm

N = 20.25cm

Y = 22.75cm



September 2020

The Coxreels TSHF-N-635 Spring Rewind Hose Reel is designed to handle various applications including diesel, kerosene, fuel oil and heating oil. The TSHF-N-635 is typically found in utility, ground support, and bulk liquid handling transport services mounted on fuel storage & dispensing systems, fuel/lube trucks, aircraft refuellers, and tank trucks.

The convenient uncoiling systems with the added hose control allow the operator to efficiently handle fuel transfers.

Manufactured to withstand the most demanding applications, the Coxreels TSHF-N-635 and its robust dual pedestal design with solid one piece steel base and support post features heavy duty CNC robotically spun & ribbed discs with rolled edges for greater strength, durability, hose protection and operator safety.

The versatile guide arm allows the TSHF-N-635 to be wall, floor, ceiling or vehicle mounted and promises years of reliable service due to a long lasting, chip resistant and rust inhibiting powder coat finish in combination with sturdy and permanently lubricated precision bearings.

## SPECIFICATIONS, FEATURES AND BENEFITS

- Supplied standard with 10m x 1" ID hose
- Machined from solid brass 90° full-flow NPT swivel inlet for fuel dispensing applications.
- Swivel seals: NITRILE
- Guide arm adjusts to wall, floor, vehicle & overhead positions
- Solid one piece, heavy gauge 1/4" steel base & support post for maximum stability
- 1" solid steel axle & lubricated precision bearings for smooth rotation
- Enclosed factory tuned & matched cartridge-style spring motor
- Non-corrosive stainless steel spring, pawl & zinc plated ratchet
- Multi-position lock ratchet mechanism secures hose at desired length
- Professional grade heavy duty steel construction
- Rolled edges & ribbed discs provide strength & safety

Also available:

- **TSHL-N-635** Bare reel

