



## PRODUCT INFORMATION

JUNE 2018



# 14514 Heavy Duty 3 Jaw Grease Gun Coupler

The Alemlube 14514 heavy duty, 3 jaw grease gun coupler is an industrial quality grease coupler for use with standard hydraulic grease nipples. With a working pressure of up to 12,000psi (827bar) the 14514 grease gun coupler has three hardened steel jaws that are designed for longevity under high pressure. The 3 jaw grease gun coupler works with all grease gun types including manual, pneumatic and battery powered grease guns.

At 39.5mm long and 15mm wide the 14514 Heavy Duty 3 jaw grease gun coupler can access those hard to reach lube points.

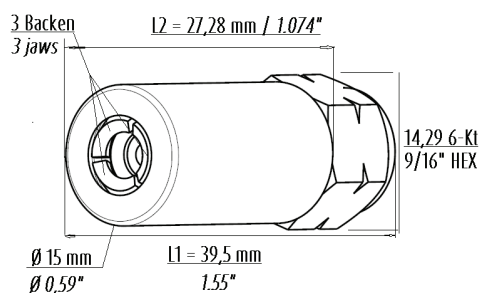
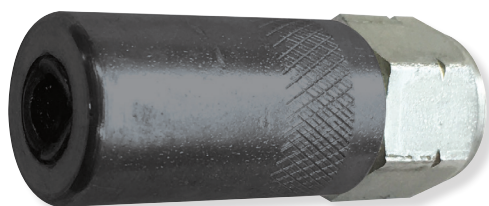

### PRODUCT SPECIFICATIONS, FEATURES AND BENEFITS

Industrial quality 3 jaw coupler for standard hydraulic grease nipples

Working pressure up to 12,000 psi (827bar)

1/8" BSPF thread

Works on all metric (DIN) and SAE specification hydraulic grease nipples

Three hardened steel jaws for resilience

Works with all grease gun types: manual, pneumatic and battery powered grease guns

Compact design enables access to difficult to reach lube points

Ensures a long service life

Easy to use just snap on and twist to pull off

Zinc black chromate plating provides rust protection

Manufactured in Germany

### ORDERING INFORMATION

**14514** Heavy Duty 3 Jaw Grease Gun Coupler

**14514-JK** 3 Jaw Spare Part Replacement Kit also available

**A14514** blister pack also available

