

Description

Model 670AN is a heavy duty 14.4V battery operated cordless grease gun suitable for 450gm grease cartridges or bulk grease. Complete with its own convenient carry case, the 670AN also comes with 2 batteries, 1 hour fast charger and a 90cm long high pressure flexible extension & hydraulic coupler. From Alemite USA, the 670AN can dispense up to nearly 9 x 450gm cartridges before recharging the NiCd battery. (585D 400gm model also available).

Specifications

Uses:	14.4V Battery Operated Cordless Grease Gun - 450gm grease cartridge or bulk grease fill. Suitable for most greases up to NLGI2.
Discharge Quantity:	High torque motor with a continuous flow rate of up to 142 grams per minute at 1,000psi.
Grease Pressure:	Develops up to 10,000psi.
Delivery:	Dispenses up to nearly 9 x 450gm cartridges of grease (4kg) @ 1,000psi.
Weight:	Lightweight at 3.2kg (empty). Ergonomic design for balance in hand. Carry strap also available.
Power:	High capacity NiCd 14.4V/1700mAh battery. 1 Hour charge time. Thermal protector for optimal motor cooling.

Loading and Priming the gun

Note: Refer to the spare parts diagram for component identification on the following procedures.

Cartridge Loading

1. Unscrew grease cylinder (36) from the gun.
2. Pull the follower rod and engage the groove in the follower rod with the slot in the grease cylinder cap.
3. Remove the plastic cap from the cartridge.
4. Apply a film of grease to the exposed inside surface of the cartridge.
Note: This is only necessary for a virgin gun.
5. Insert the cartridge into the grease cylinder
– (Remove the tabbed seal from the cartridge).
6. Screw the grease cylinder onto the gun.
7. Disengage the follower rod from the slot in the grease cylinder cap
– (Push the follower rod into the grease cylinder).

Suction Loading

1. Unscrew grease cylinder (36) from gun.
2. Insert the head of the grease cylinder below the surface of the grease.
3. Slowly pull the follower rod outward from the grease cylinder cap until the groove is visible.
4. Engage the groove in the follower rod with the slot in the grease cylinder cap.
5. Screw the grease cylinder onto the gun.
6. Disengage the follower rod from the slot in the grease cylinder cap
– (Push the follower rod into the grease cylinder).

Loader Pump

The Loader fitting on the gun must mate with the loader coupler. The pump may not operate if the components are not compatible.

1. Pull the follower rod & engage follower by rotating the rod.
2. Seat the loader fitting into the loader coupler – (Push down to hold the coupler valve open).
3. Operate the pump & view the movement of the follower rod.
4. Discontinue pump operation once the groove on the follower rod is visible.
5. Disengage follower rod from follower and push into the grease cylinder.

Priming the gun

In most cases the gun will prime supply by operating the trigger several times. Should the grease fail to appear, air must be bled.



Force Prime

This process manually assists air within the gun to be bled at the Bleed Valve.

1. Put the follower rod & engage follower by rotating the rod.
2. Depress Bleed Valve (48) and at the same time push on the follower rod. Once the air is eliminated, operate the gun several times. Once grease appears, disengage the follower rod from the follower and push into the grease cylinder.

Gun Operation

Battery pack (37) is intentionally shipped with a low charge.

Charge battery pack prior to use. Refer to the following section for details.

Important To Note

The battery pack must be discharged and recharged several times before achieving a full charge.

Air pockets in the grease can cause the gun to lose prime. Check for prime after each refill and before lubrication.

The gun is equipped with a thermal protector to prevent the motor from overheating. When a blocked bearing, line, or grease fitting causes the gun to stall, the thermal protector will stop and restart the motor every 2-3 seconds. For maximum motor life, avoid operating at stall.

Check Valve Contamination

Should the gun fail, the outlet check may be held open. Remove plug (41), clean Ball (44) & the ball seat of head (16).

Battery Pack and Charger Safety Rules

This manual contains safety and operating instructions for Battery Pack part number 339992 and Battery charger 340082.

Warning

Before using the Battery Charger read all instructions and cautionary markings on Battery Charger (55), Battery Pack (37) and products using the Battery Pack.

To reduce the risk of injury, charge only Nickel Cadmium type rechargeable batteries. Other types of batteries may burst causing injury.

An extension cord should not be used unless absolutely necessary. Use of an improper extension cord could result in a risk of fire and electric shock. If an extension cord must be used, make sure it is 16 gauge. Check to ensure that the pins on the plug of the extension cord are the same number, size, and shape as those of the plug on the Charger. Make sure that the extension cord is properly worried and in good electrical condition.

Do not incinerate the Battery Pack, even if it is severely damaged or completely worn out. The Battery Pack may explode in fire.

Do not expose the Charger to rain, snow or frost.

To reduce the risk of damage to electric plug and cord, pull by the plug rather than the cord when disconnecting the Charger.

Make sure the cord is located so that it will not be stepped on, tripped over, or otherwise subjected to damage or stress.

Do not operate the Charger with damaged cord or plug. Replace immediately.

Do not operate the Charger if it has received a sharp blow, been dropped, or otherwise damaged in any way.

Do not disassemble the Charger.

Do not charge the Battery Pack when the temperature is below 10°C (50°F) or above 35°C (95°F).

The Charger is designed to operate on standard household electrical power. Do not attempt to use it on any other voltage.

Consecutive charging may cause overheating. If you need to recharge the Battery packs consecutively, wait for about 15 minutes to allow the Charger to cool.

Do not insert foreign material into the hole for the Battery Pack in the Charger stand.

Do not disassemble the Battery Pack.

Do not store the gun and battery pack assembly in locations where the temperature may reach or exceed 40°C (104°F).

Do not short circuit the Battery Pack.

Do not discharge the Battery Pack beyond normal use limits. Further discharging (such as placing a rubber band on the trigger) can cause a deep discharge which may result in the polarity reversal of a cell rendering the Battery Pack useless.

Do not place the Charger in an area of extreme heat or cold. It works best at normal room temperature.

The Battery Pack contains rechargeable nickel-cadmium batteries. These batteries must be recycled or disposed of properly. Drop off expended Battery Pack at your local replacement battery retailer or your local recycling center.

Battery Charger Operation

Charge the Battery Pack only with the Charger provided.

Recharging the Hot Battery Pack

When using the gun continuously, the Battery Pack will become hot. Allow the Battery Pack to cool for approximately 30 minutes before attempting to recharge.

Head Office NSW
TEL: (02) 9939 0711
FAX: (02) 9939 0411

VIC
TEL: (03) 8787 8288
FAX: (03) 8787 8266

QLD
TEL: (07) 3889 8480
FAX: (07) 3889 8490

SA/NT
TEL: (08) 8241 7111
FAX: (08) 8241 7011

WA
TEL: (08) 9209 3066
FAX: (08) 9209 3933

TAS
TEL: (03) 6343 0477
FAX: (03) 6343 0911

When the Battery Pack becomes discharged and is hot, the green lamp on the Charger glows continuously. The green lamp indicates slow charging mode.

Recharging Normal Battery Pack

Position the Battery Pack into the Charger. Press down to ensure the Battery operation engages with charger's contact.

Normally the yellow and green lamps on the Charger will illuminate. This indicates the Charger is in control mode and should switch to fast mode within 5 minutes. When the Charger is in fast charge mode the red lamp illuminates.

If after a period of 15 minutes the yellow and green lamps remain on, remove the Battery Pack, wait 1 minute and re-insert the Battery Pack into the Charger. If the yellow and green lamps continue to remain on an additional 15 minutes, the Battery Pack is damaged and will not accept charge.

When the Battery Pack becomes fully charged, the red lamp turns off and the green lamp turns on.

After normal usage, 1 hour of charge time is required to be fully charged. A minimum charge time of 1 to 1-1/2 hours is required to recharge a completely discharged Battery Pack.

The Battery Pack will become slightly warm to touch while charging. This is normal and does not indicate a problem.

Warranty

Your 670AN battery operated cordless grease gun is covered by a 12 month manufacturer's warranty from date of purchase. If you require any repair or service work please call us on any of the telephone numbers listed below or visit our website for more information.

We hope you enjoy hours and years of trouble free greasing with your new 670AN from Alemite Lubrequip P/L.

Head Office NSW TEL: (02) 9939 0711 FAX: (02) 9939 0411	VIC TEL: (03) 8787 8288 FAX: (03) 8787 8266	QLD TEL: (07) 3889 8480 FAX: (07) 3889 8490	SA/NT TEL: (08) 8241 7111 FAX: (08) 8241 7011	WA TEL: (08) 9209 3066 FAX: (08) 9209 3933	TAS TEL: (03) 6343 0477 FAX: (03) 6343 0911
--	--	--	--	---	--

Parts and Drawing Breakdown For 670AN

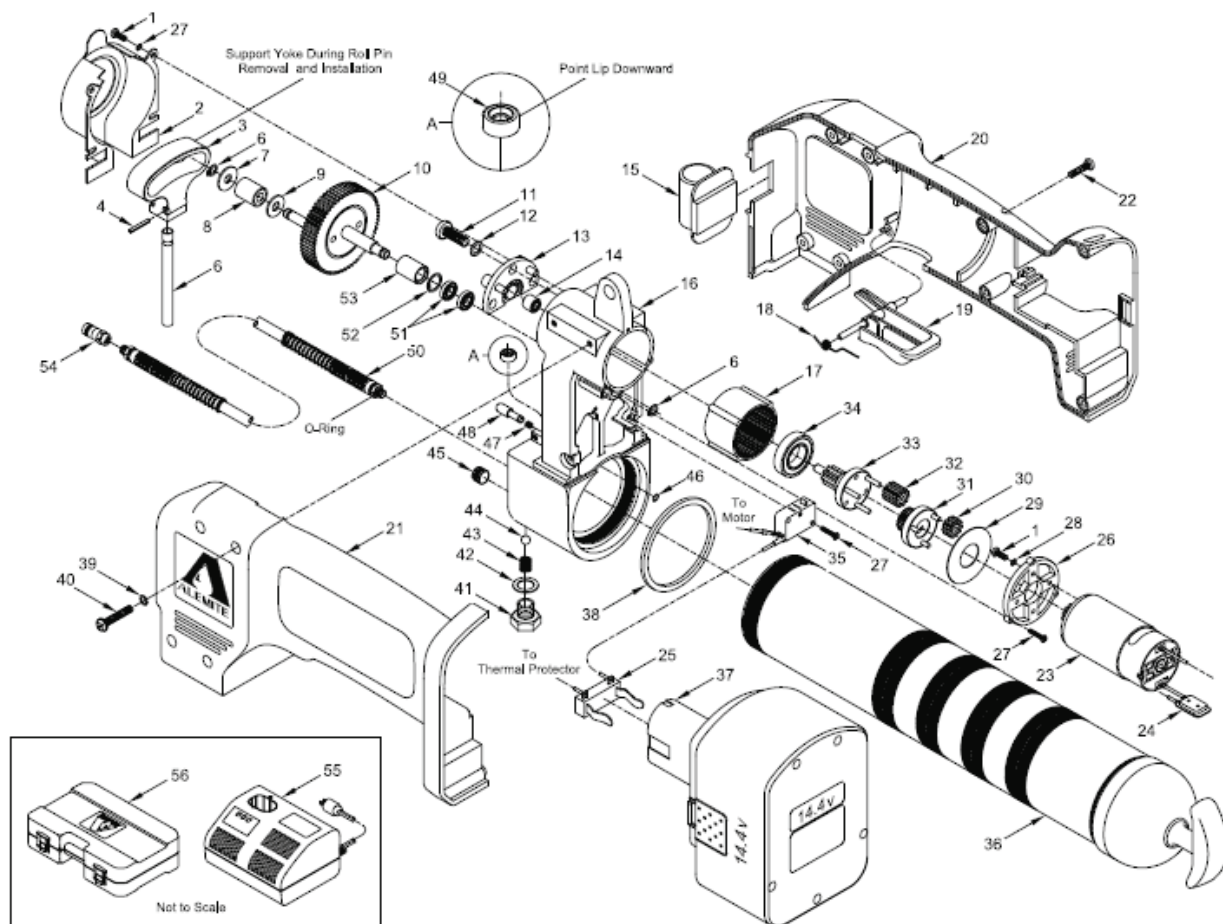

Ordering Spare Parts

Parts List – Part No. 670AN

Item Number	Part number	Description	Qty
1		Screw	6
2	393756-14	Cover, Head	1
3		Yoke	1
4		Pin, Roll	2
5		Piston	1
6		Ring, Retaining	2
7		Washer, 0.24" ID x 0.67" OD	1
8		Bearing, Roller	1
9		Washer 0.24" ID x 0.59" OD	1
10		Gear Assembly, Output	1
11		Screw, M5 x 15	3
12		Washer, Lock	3
13		Holder, Assembly, Bearing	1
14		Bearing Needle	1
15	393756-1	Holder	1
16		Head	1
17		Gear, Internal	1
18		Spring, Trigger	1
19		Trigger	1
20		Cover, Housing Right	1
21		Cover, Housing Left	1
22		Screw	4
23	393756-17	Motor Assembly (with Sun gear)	1
24		Protector Thermal	1
25		Contact Assembly Battery	1

Head Office NSW
TEL: (02) 9939 0711
FAX: (02) 9939 0411

VIC
TEL: (03) 8787 8288
FAX: (03) 8787 8266

QLD
TEL: (07) 3889 8480
FAX: (07) 3889 8490

SA/NT
TEL: (08) 8241 7111
FAX: (08) 8241 7011

WA
TEL: (08) 9209 3066
FAX: (08) 9209 3933

TAS
TEL: (03) 6343 0477
FAX: (03) 6343 0911

26	393756-15	Mount, Motor	1
27		Screw, M3 x 16	5
28		Washer, Lock	6
29		Washer	1
30		Gear, Planet (1 st stage)	3
31		Gear Sun (2 nd stage)	1
32		Gear Planet (2 nd stage)	3
33		Gear, Output Pinion	1
34		Bearing Ball	1
35	393756-5	Switch	1
36	600A-B	Barrel Assembly, 450gm	1
36A	339820	Barrel Assembly, 400gm	1
-	670AN-AD	Barrel to Head Adaptor, 450gm	1
37	339992	Battery Pack, 14.4V	1
38	336523	Gasket	1
39		Washer. Lock	8
40		Screw	8
41		Plug, Check	1
42		Gasket (Copper)	1
43		Spring, Check	1
44		Ball, Check 3/8" Diameter	1
45		Plug	1
46		O-Ring	1
47		Spring, Bleed Valve	1
48		Valve, Bleed	1
49		Seal, Piston	1
50	340067	Hose Assembly, grease	1
51		Bearing Ball	2
52		Ring, Internal Retaining	1
53		Bearing Needle	1
54	6304-B	Coupler, grease	1
55	340082	Charger Assembly Battery	1
56		Case, Carrying	1

*Not all items available for sale as individual spare parts. Some items only available as part of a kit. Please enquire as required.

Head Office NSW
TEL: (02) 9939 0711
FAX: (02) 9939 0411

VIC
TEL: (03) 8787 8288
FAX: (03) 8787 8266

QLD
TEL: (07) 3889 8480
FAX: (07) 3889 8490

SA/NT
TEL: (08) 8241 7111
FAX: (08) 8241 7011

WA
TEL: (08) 9209 3066
FAX: (08) 9209 3933

TAS
TEL: (03) 6343 0477
FAX: (03) 6343 0911